

ITEM NO.	PART NUMBER	DESCRIPTION	QTY.
1	ENC-045-1_A	SIDE WALL, LEFT	1
2	ENC-045-2_A	SIDE WALL, RIGHT	1
3	ENC-045-3_A	UPPER CROSSMEMBER	1
4	ENC-045-4_A	LOWER CROSSMEMBER	1
5	ENC-045-5_A	REAR WALL	1
6	ENC-045-6_A	DOOR	1
7	ENC-045-7_A	LID	1
8	NY-FLT-WSH	NYLON FLAT WASHER	20
9	1/4-20-CAR-BLT	1/4-20 X .750" GRADE 5 CARRIAGE BOLT	2
10	1/4-20-KEPS	1/4-20 KEPS NUT W/LOCK WASHER	18
11	GAS-SPR-SHK	GAS SPRING SHOCK	2

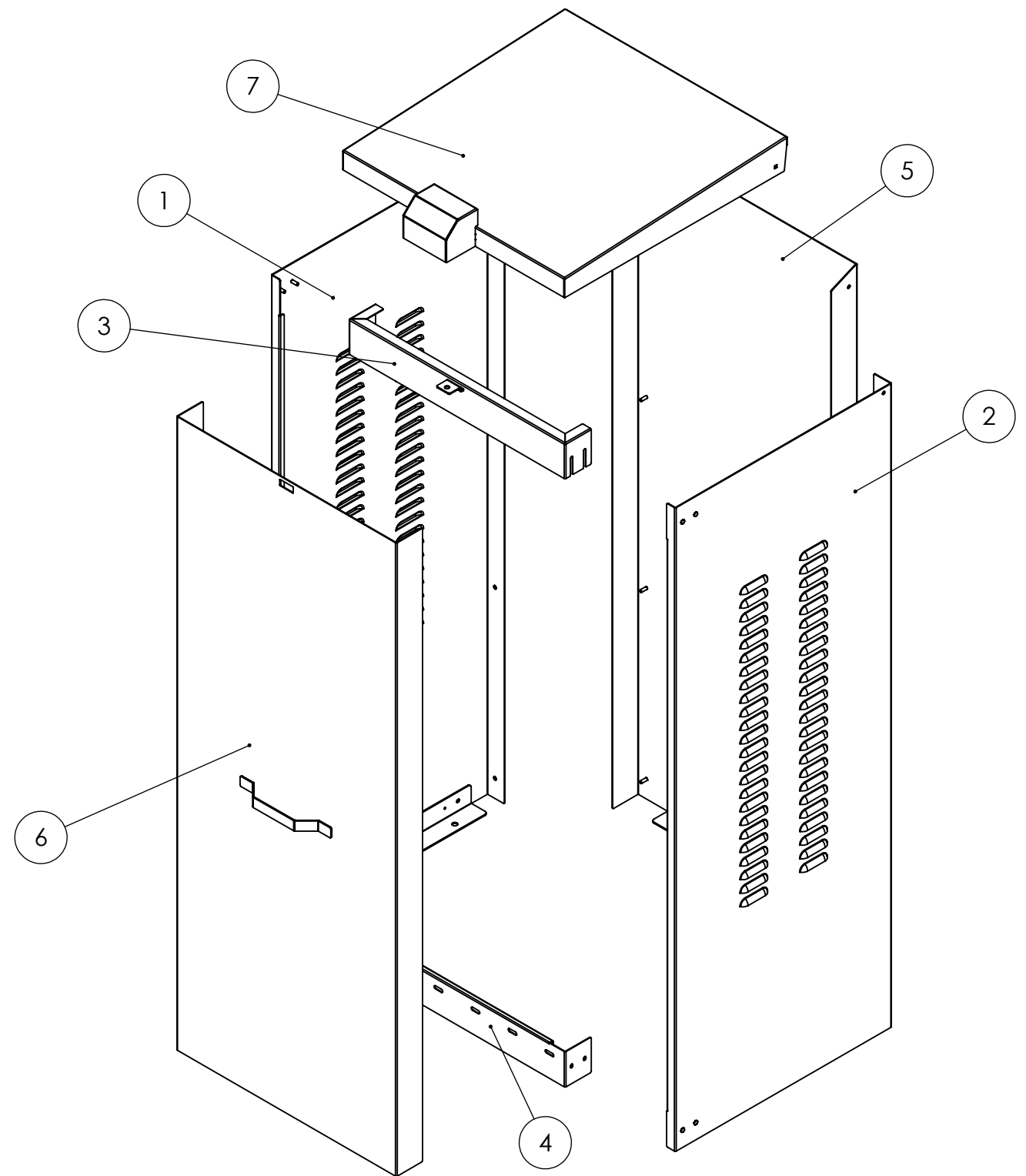

SCALE	SIZE	PART #	REV
	B	ENC-045	A
DO NOT SCALE		SHT 1 OF 3	

1.) FIT WALLS (ITEMS 1 & 2) OVER BOLTS IN REAR WALL (ITEM 5) AND SLIDE LOWER CROSSMEMBER (ITEM 4) INTO PLACE BETWEEN SIDE WALLS

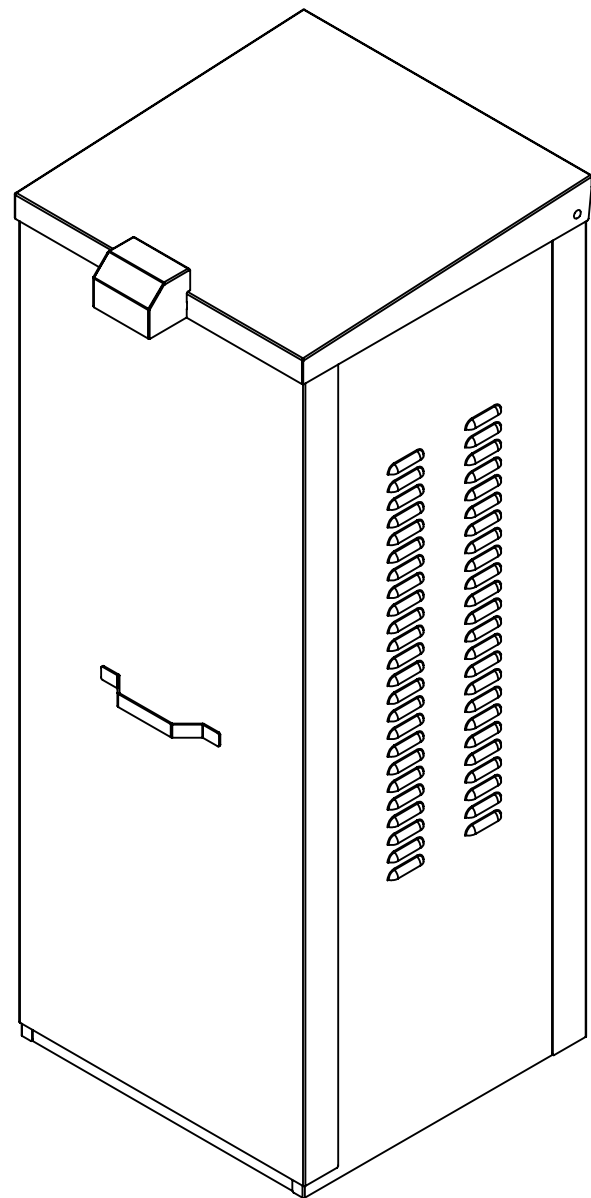
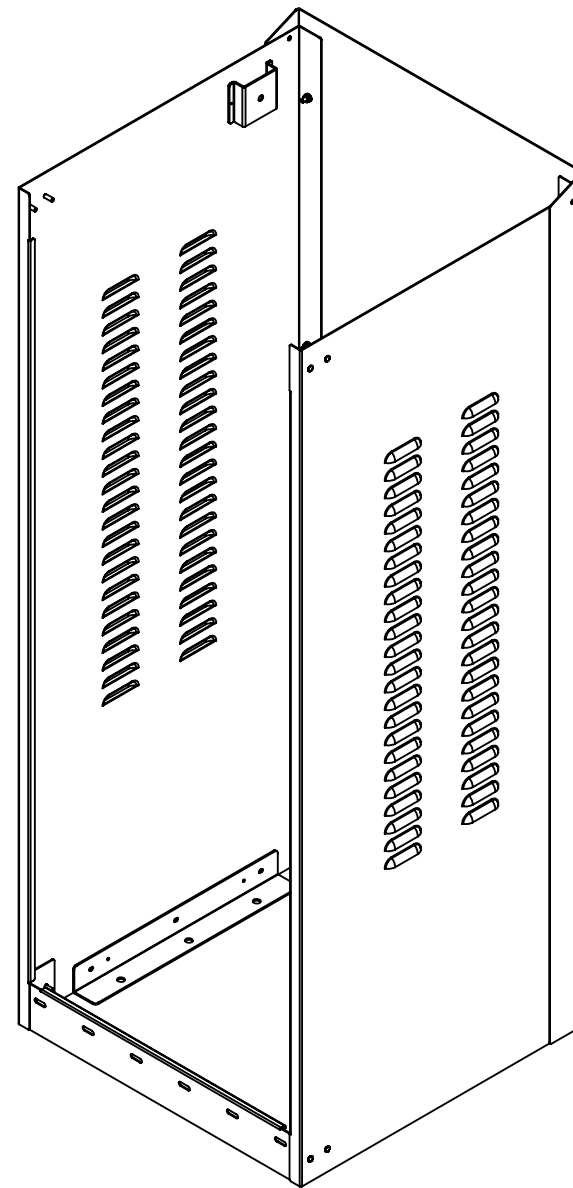
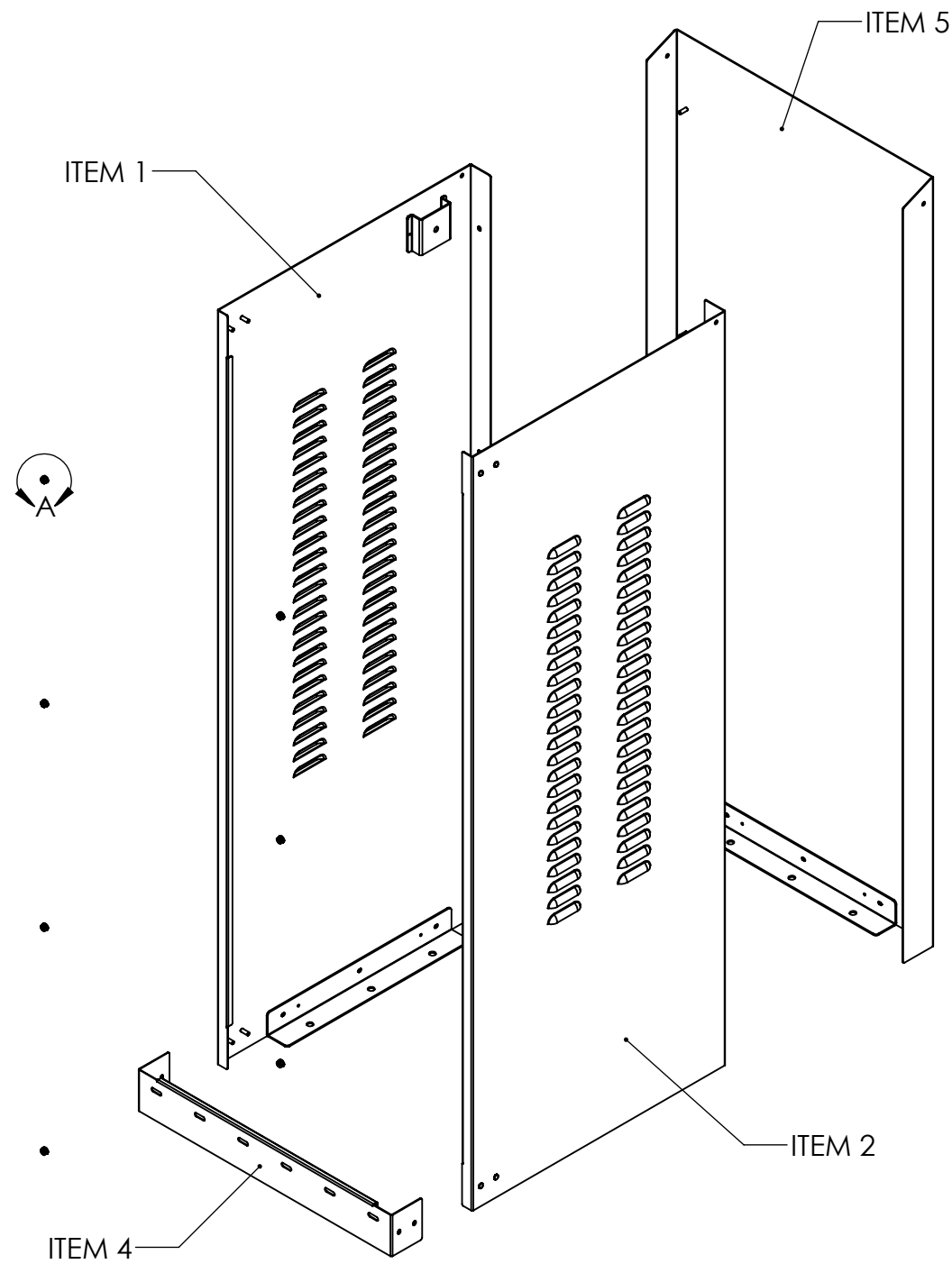

3.) ONCE THE TANK IS INSTALLED, SLIDE UPPER CROSSMEMBER (ITEM 3) INTO POSITION, FITTING SLOTS OVER 1/4-20 BOLTS IN SIDE WALLS. SECURE USING NYLON WASHERS/KEPS NUTS

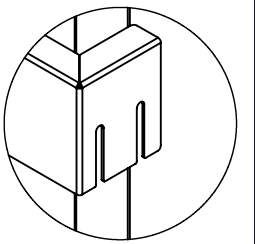
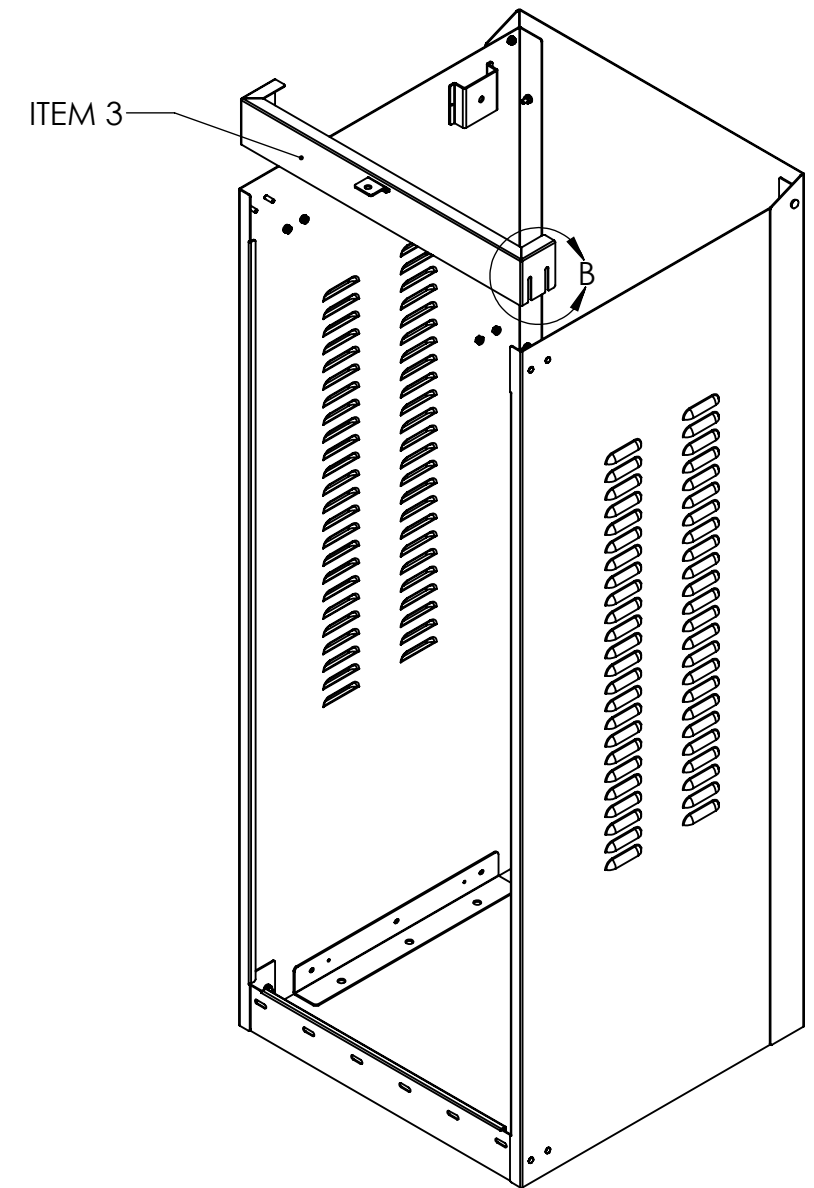

DETAIL B
SCALE 1 : 5

2.) USING NYLON WASHERS/KEPS NUTS AS SHOWN, SECURE ITEMS 1 & 2 TO ITEM 5, THEN SECURE ITEM 4 TO ITEMS 1 & 2. WHEN THIS STEP IS COMPLETE, MOVE ENCLOSURE INTO DESIRED POSITION. SECURE TO GROUND AND INSTALL TANK

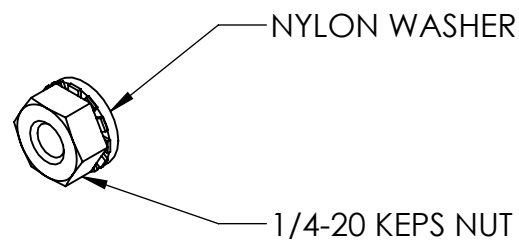

DETAIL A
SCALE 1 : 1

SCALE	SIZE	PART #	REV
	B	ENC-045	A
DO NOT SCALE		SHT 2 OF	3

**4.) ATTACH LID TO ENCLOSURE USING
1/4-20 CARRIAGE BOLTS, KEPS NUTS AND WASHERS
AS SHOWN. THREAD ENDS OF SHOCKS INTO
BRACKET HARDWARE AS INDICATED**

THREAD ENDS OF SHOCK
INTO HARDWARE ON
SIDE BRACKET AND LID
UNTIL FULLY ENGAGED

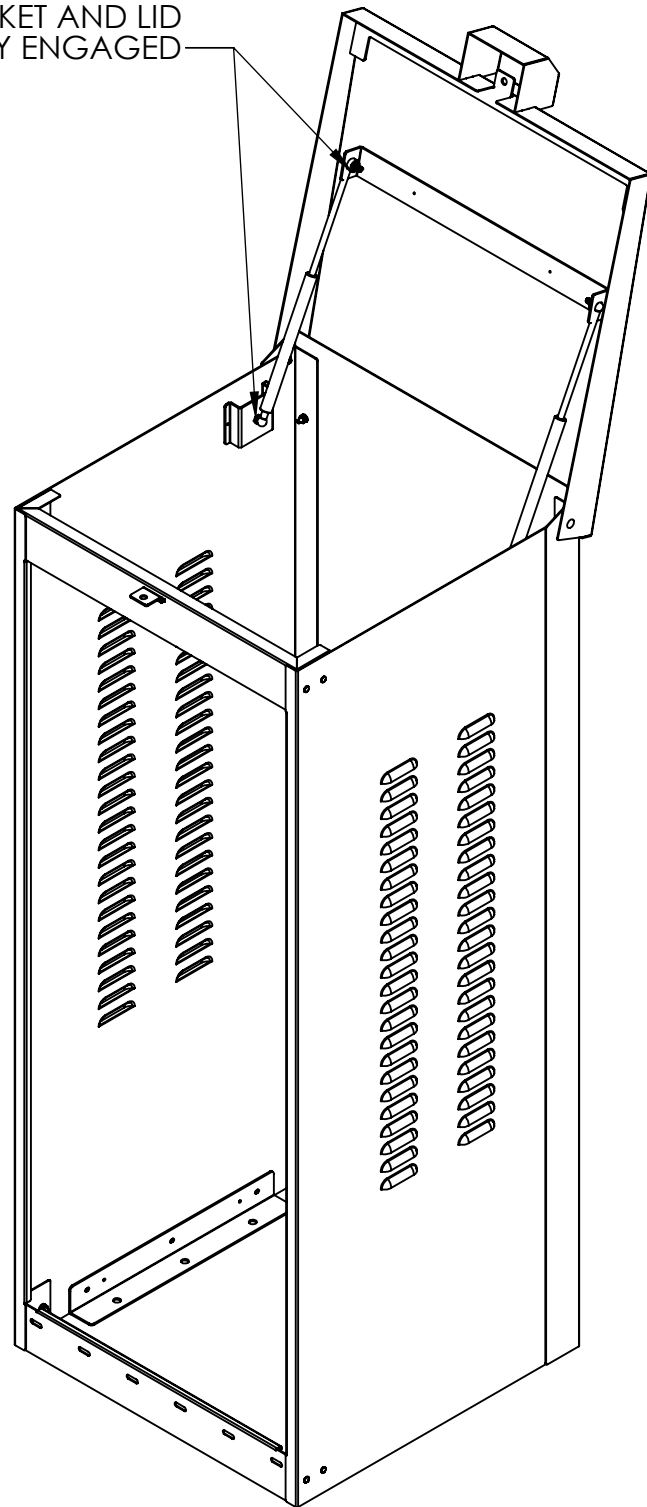

LOCK HASP

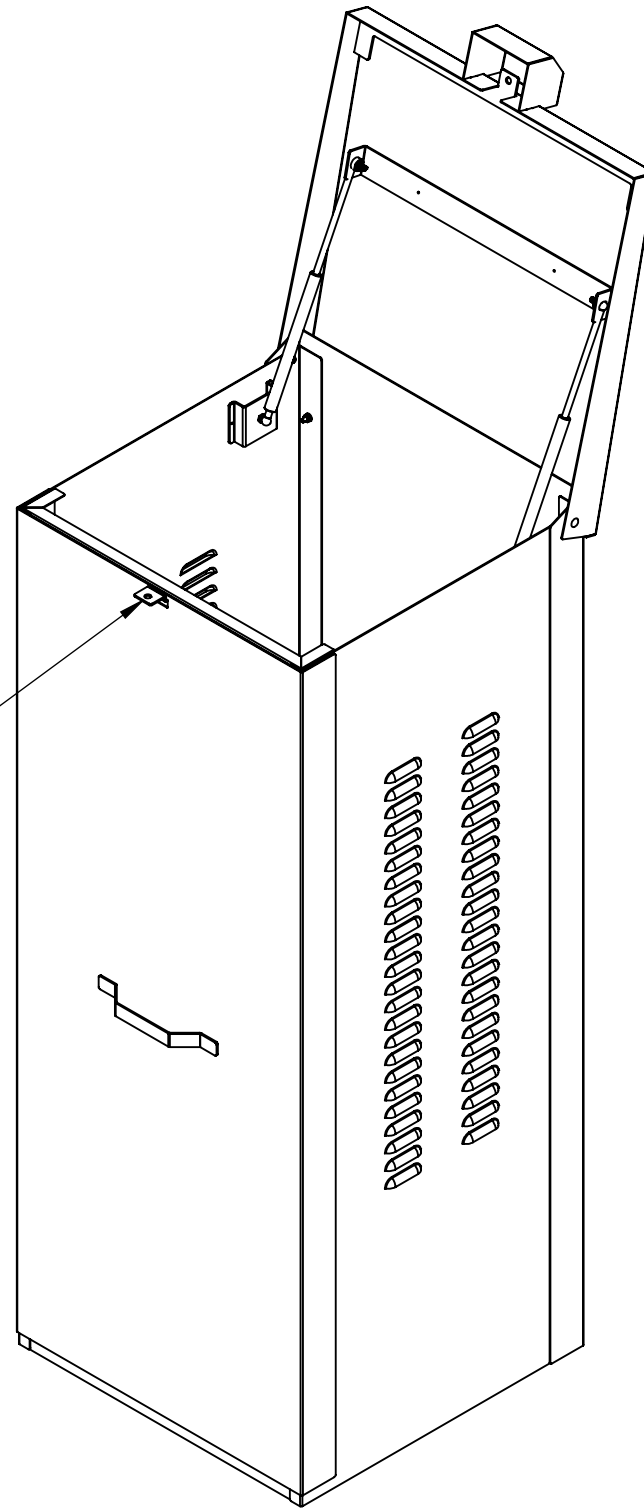

**6.) CLOSE LID OVER DOOR
AND SECURE ENCLOSURE WITH PADLOCK**

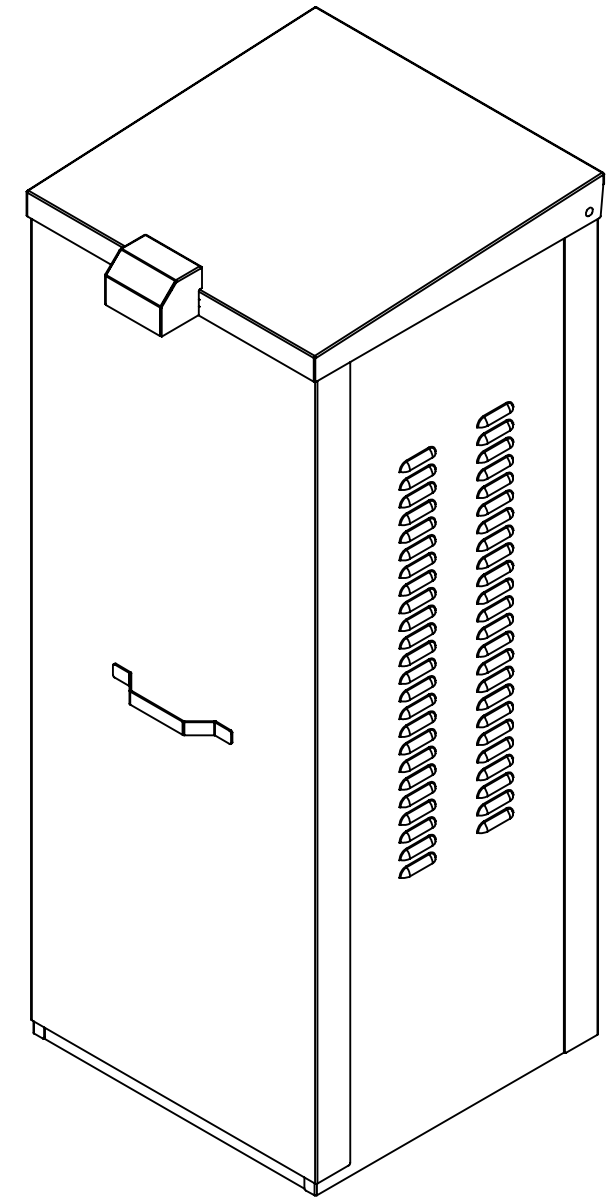

**5.) PLACE DOOR IN CLOSED POSITION
BY SLIDING OVER LOCK HASP AND
DROPPING RETAINING FLANGE
ONTO LOWER CROSSMEMBER**

SCALE	SIZE B	PART # ENC-045	REV A
DO NOT SCALE		SHT 3 OF 3	