

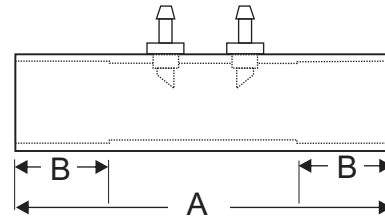

*A Landscape Solutions Company™*

## EZ Slip Coupling Connector

Slip coupling connectors are available in sizes from 3/4" to 2" with socket x socket connections. They are PVC schedule 40 with 1/4" nylon barbed tubing connectors. They are used to connect the EZ-FLO system to the irrigation flow line with the 1/4" flexible tubing provided with the EZ-FLO system. These connectors are principally used in new installations or in retrofits where there is adequate room to flex the irrigation pipe. **Not recommended for EZ005 and larger models.**  
 \*Larger sizes available upon request.



Part Number	Size	A	B
C-075	3/4" Soc	4 1/4"	1"
C-100	1" Soc	4 3/4"	1 1/4"
C-125	1 1/4" Soc	5 3/4"	1 1/4"
C-150	1 1/2" Soc	5 3/4"	1 1/4"
C-200	2" Soc	6 1/2"	1 1/2"

## EZ Ball Valve Coupling Connector

Ball valve coupling (CBV) connectors are available in sizes 3/4" through 4" with socket x socket connections. They are PVC schedule 40 with 1/4" nylon barbed tubing connectors. They are used to connect the EZ-FLO system to the irrigation flow line with the 1/4" flexible tubing provided with the EZ-FLO system when the elevation of zone valves downstream from the EZ-FLO System installation point are at an elevation 10 feet or more above the installation point. They provide the ability to adjust the differential pressure between the inlet and outlet connection to the irrigation system flow line. **CBV's are REQUIRED for EZ005-FX, EZ010-FX and for all HC models** unless an approved engineered connection has been specified.

\*Other sizes are available. Please contact technical support for additional information.

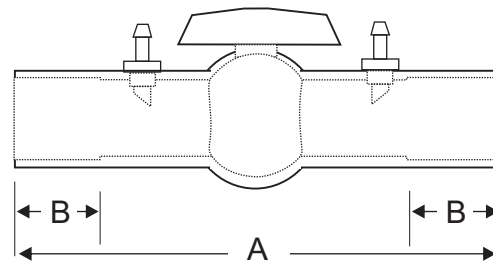

Part Number	Size	A	B
CBV-075	3/4" Soc	7"	1"
CBV-100	1" Soc	8"	1 1/4"
CBV-125	1 1/4" Soc	9 1/2"	1 1/4"
CBV-150	1 1/2" Soc	10 3/4"	1 1/4"
CBV-200	2" Soc	12 1/2"	1 3/4"
CBV-250	2 1/2" Soc	13"	1 3/4"
CBV-300	3" Soc	16 1/2"	1 3/4"
CBV-400	4" Soc	18 1/2"	2"